



FLOW
LEVEL
PRESSURE
ANALYTICAL
TEMPERATURE
INSTRUMENTATION
PASTEURIZATION CONTROLS



"IZMAG" Electromagnetic Flowmeter

- $\pm .20\%$ accuracy
- Compact design fits challenging applications
- Stainless steel housing suitable for all processing environments
- 3-A compliant; Third party verified in accordance with standard 28-04

The IZMAG is Anderson Instrument Company's next generation of electromagnetic flow meter. Building on the qualities that have made it's predecessor, the IZMS meter, the industry standard in accuracy and longevity, the IZMAG incorporates new design and performance features that allow the IZMAG to excel in the most demanding sanitary processing environment.

From the outside, one will recognize that a compact, all stainless steel housing now provides the highest level of protection from the cleaning chemicals and environmental extremes present in food processing facilities. A standard backlit graphic display provides the metering information not only as numbers and text but also has the ability to display images. By using images along with text a more intuitive feel to navigation is achieved making the programming

experience quicker and simpler. On the inside a PFA liner offers increases in pressure, temperature and vacuum capability. This new liner gives the IZMAG the ability to satisfy an expanded list of high temperature and aseptic applications .

In addition to the other features the flow meter has a compact overall size allowing installation into tight fitting applications without a sacrifice in measurement performance.

Complete specifications and ordering information are available on the reverse side. For more information please visit our website at www.andinst.com or contact your local authorized Anderson distributor.

APPLICATIONS

- Milk
- Cream
- Beer
- Tomato Paste
- Sauces
- Molasses
- Yogurt
- Slurries
- Concentrates
- Cleaning solutions



IZMAG Complete Product Ordering Matrix

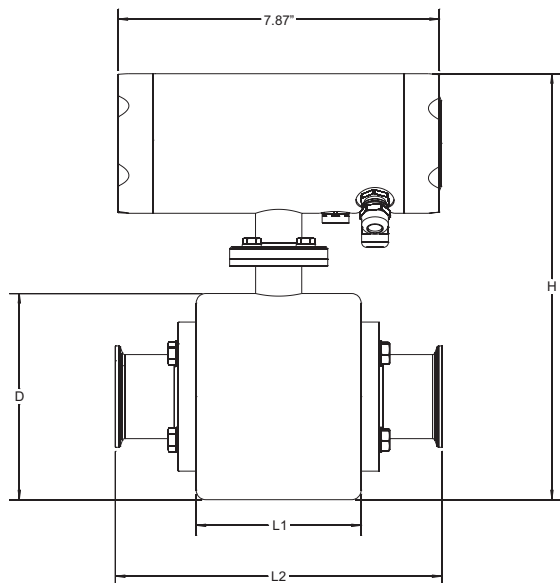
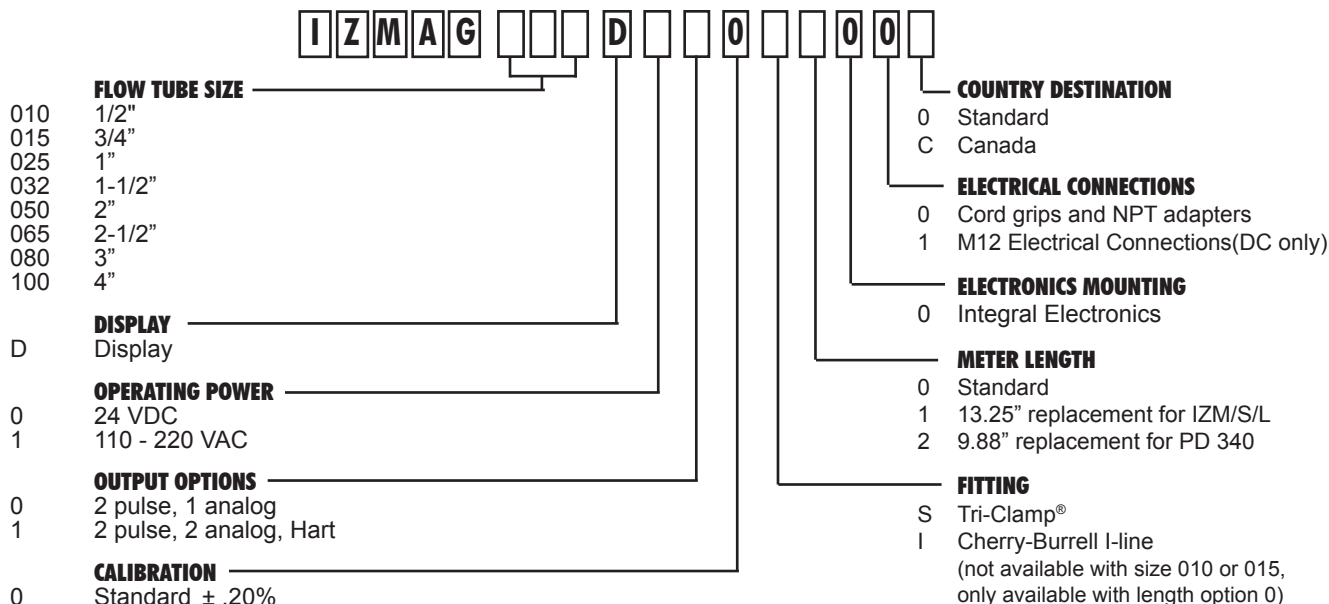

Spare Parts

Part Number	Description	Quantity needed
45669A0010	EPDM connection seals 1/2"	2
45669A0015	EPDM connection seals 3/4"	2
45669A0025	EPDM connection seals 1"	2
45669A0032	EPDM connection seals 1.5"	2
45669A0050	EPDM connection seals 2"	2
45669A0065	EPDM connection seals 2.5"	2
45669A0080	EPDM connection seals 3"	2
45669A0100	EPDM connection seals 4"	2

Flowtube	D	H	L1	L2				Weight (lbs)
				Length Option			Fitting Option	
				0	1	2	I	
1/2"	3.54"	8.86"	4.09"	6.75"	-	-	-	14.4
3/4"	3.54"	8.86"	4.09"	8.00"	13.25"	9.88"	13"	14.4
1"	3.54"	8.86"	4.09"	8.00"	13.25"	9.88"	13"	14.6
1-1/2"	4.13"	9.45"	4.09"	8.00"	13.25"	9.88"	13"	17.0
2"	5.12"	10.43"	4.09"	8.00"	13.25"	9.88"	13"	19.8
2-1/2"	5.12"	10.43"	4.09"	9.00"	13.25"	9.88"	13"	20.8
3"	6.10"	11.42"	4.33"	9.88"	13.25"	9.88"	13"	31.0
4"	6.69"	12.01"	4.33"	9.88"	13.67"	9.88"	14"	42.0

Specifications:

PERFORMANCE

Accuracy: $\pm .20\%$ of rate*

Size	Operational Flow Range	
	gal/min	ltr/min
10	0.14 - 14	0.53 - 53
15	0.3 - 30	1.13 - 113
25	0.8 - 80	3.0 - 300
32	1.3 - 130	5.0 - 500
50	3 - 300	11.7 - 1166
65	5.2 - 525	20 - 2000
80	8 - 800	30 - 3000
100	12 - 1200	46 - 4667

* ± 1 mm/sec

OPERATING / ENVIRONMENTAL

Temperature Limits:	32-212°F (0-100°C) Process 32-265°F (0-165°C) for 30 min. CIP
Ambient Temperature	DC -12 - 130°F(-25-55°C) AC -12 - 120°F(-25-45°C)
Pressure Rating:	1.4-145 psi abs. .1 - 11 bar abs.
Product Requirements:	5 μ S min. conductivity
Approvals:	ETL, CE, 3-A

MATERIALS / CONSTRUCTION

Product Contact Surfaces: PFA 316L SS, EPDM
Housing: 304 SS
Enclosure Rating: IP 67
Process Connection Type: Tri-clamp®, Cherry I-line

ELECTRICAL / POWER / SIGNAL

Power Requirement: 9-32 VDC 7W/V.A.
100-240 VAC 50-60hz
-15% / + 10% 7W/V.A.

Signal Output:
(2) digital pulse output
24VDC @20 mA
(1) digital status output
24VDC @20 mA
(1) 4-20mA passive/active
Optional 2nd 4-20mA w/Hart (passive)

Control Input:
Connections:
(1) 9-32 VDC R<3.2kohms
(3) M16 ports with cord grips and 1/2" conduit adapters

Display:
Graphic LCD
46 X23mm illuminated

Communications:
Hart ver. 6, CS3 BUS

Above specifications are developed from engineering design and testing done at Anderson Instrument Co.

FORMAIC 5067 ©8/10
Revised: November 2011
Supersedes: August 2011